

Welcome and opening remarks by the Chairman and members of the Board of Directors

Agenda Item #1

May 31, 2017



CENTRAL TEXAS
Regional Mobility Authority

Opportunity for public comment

Agenda Item #2

May 31, 2017



CENTRAL TEXAS
Regional Mobility Authority

Consent Agenda

Agenda Items #3-5

May 31, 2017



CENTRAL TEXAS
Regional Mobility Authority

Regular Items

Agenda Items #6-10

May 31, 2017



CENTRAL TEXAS
Regional Mobility Authority

Approve the minutes for the April 26, 2017 Regular Board meeting and from the May 15, 2017 Board Workshop meeting

Agenda Item #6

Geoff Petrov, General Counsel

May 31, 2017



CENTRAL TEXAS
Regional Mobility Authority

Accept the financial statements for April 2017

Agenda Item #7

Mary Temple, Controller

May 31, 2017



CENTRAL TEXAS
Regional Mobility Authority

Presentation of the draft budget for Fiscal Year 2017- 2018

Agenda Item #8

Mary Temple, Controller

May 31, 2017



CENTRAL TEXAS
Regional Mobility Authority

Discuss and take appropriate action to rescind primacy for the east to south direct connector on the Manor Expressway (290E) Phase III Project

Agenda Item #9

Justin Word, P.E., Director of Engineering

May 31, 2017



CENTRAL TEXAS
Regional Mobility Authority

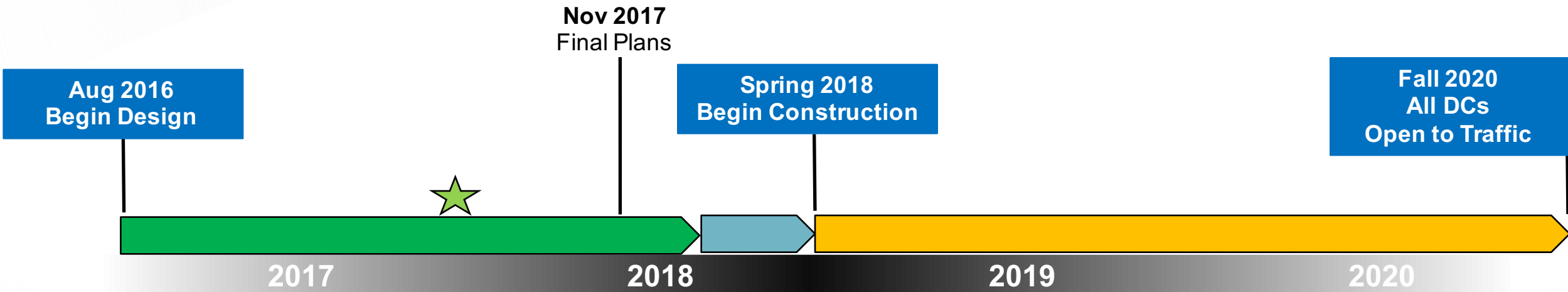

LEGEND

DESIGN

PROCUREMENT

CONSTRUCTION



TODAY



PRIMACY

- Board Declared Primacy September 28, 2016

TxDOT REQUEST

- MA to Develop/Construct East 290 to South 130 (ESDC)
- TxDOT to Reimburse Mobility Authority for ESDC
- TxDOT will operate ESDC as part of Central Texas Turnpike System
- TxDOT assumes ESDC Final Maintenance

ACTION

- Would require Board To Rescind Primacy on ESDC
- Contingent on TxDOT Funding Commitment





Project Development Agreement (PDA)

- Design PDA Executed 3/27/17
- Negotiating PDA for Construction, Operations and Maintenance
- Expect Execution in July 2017

Advance Funding Agreement (AFA)

- AFA Application submitted to TxDOT 4/27/17
- Allow TxDOT to Reimburse Mobility Authority for ESDC on their behalf (\$41.1M)
- Expect Execution in July 2017

Discuss and consider authorizing the procurement of a contractor for miscellaneous work related to the MoPac Improvement Project

Agenda Item #10

Justin Word, P.E., Director of Engineering

May 31, 2017



CENTRAL TEXAS
Regional Mobility Authority



- **Work includes elements related to the MoPac Improvement Project**
 - Shared use path at US 183
 - Two new soundwalls along MoPac
 - ⌘ Westminster property along East side of MoPac, south of 45th St. between 35th St. and 45th St.
 - ⌘ West side of MoPac, south of RM 2222
 - Aesthetic details to existing soundwalls along MoPac
 - Retaining wall rehabilitation at MoPac and RM 2222
 - Miscellaneous projects
- **Anticipated letting in late summer with construction underway in late 2017**

Briefings and Reports

Agenda Items #11-13

May 31, 2017



CENTRAL TEXAS
Regional Mobility Authority

Executive Director's Report

A. Texas 85th Legislature Update

Agenda Item #11A

Mike Heiligenstein, Executive Director

May 31, 2017



CENTRAL TEXAS
Regional Mobility Authority

Executive Director's Report

B. Interoperability with Kansas Turnpike Authority

Agenda Item #11B

Tim Reilly, Director of Operations

May 31, 2017



CENTRAL TEXAS
Regional Mobility Authority

Executive Director's Report

C. Commissioner Shea's meeting regarding urban cable

Agenda Item #11C

Mike Heiligenstein, Executive Director

May 31, 2017



CENTRAL TEXAS
Regional Mobility Authority

183 North Delivery Model Update

Agenda Item #12

Justin Word, P.E., Director of Engineering

May 31, 2017



CENTRAL TEXAS
Regional Mobility Authority

Project Delivery Method Comparison



Activity	Design-Bid-Build	Design-Build
Contracts	<ul style="list-style-type: none"> Two contracts (Engineer and Contractor) 	<ul style="list-style-type: none"> One contract (Developer includes design and construction)
Engineer Selection	<ul style="list-style-type: none"> Through Request For Qualifications/Request for Proposals process 	<ul style="list-style-type: none"> Included in developer team, not directly selected
Contractor Selection	<ul style="list-style-type: none"> Low bid 	<ul style="list-style-type: none"> Shortlist of qualified bidders Selection process includes both technical and price
Design	<ul style="list-style-type: none"> Mobility Authority performs design 	<ul style="list-style-type: none"> Developer performs design
Utility Adjustments	<ul style="list-style-type: none"> Mobility Authority Responsibility 	<ul style="list-style-type: none"> Developer Responsibility
Sequence of Work	<ul style="list-style-type: none"> Linear: construction follows completed design and utility relocations 	<ul style="list-style-type: none"> Packaging of design work to allow for early construction

Management Responsibility Comparison



DESIGN-BID-BUILD

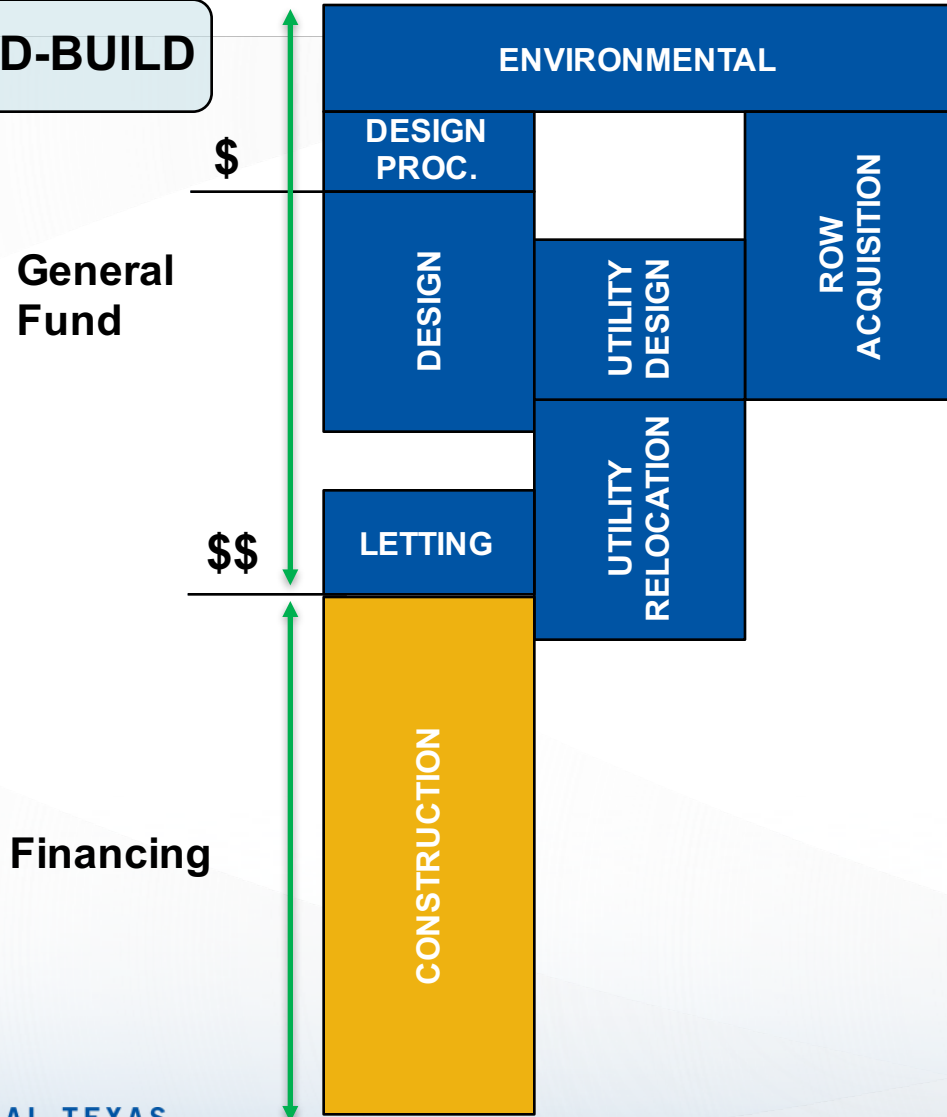

DESIGN-BUILD

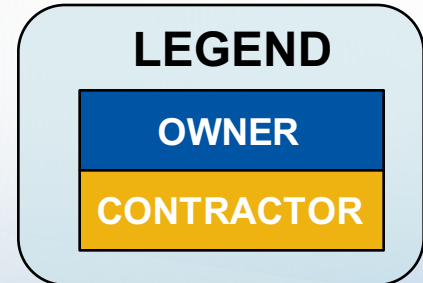
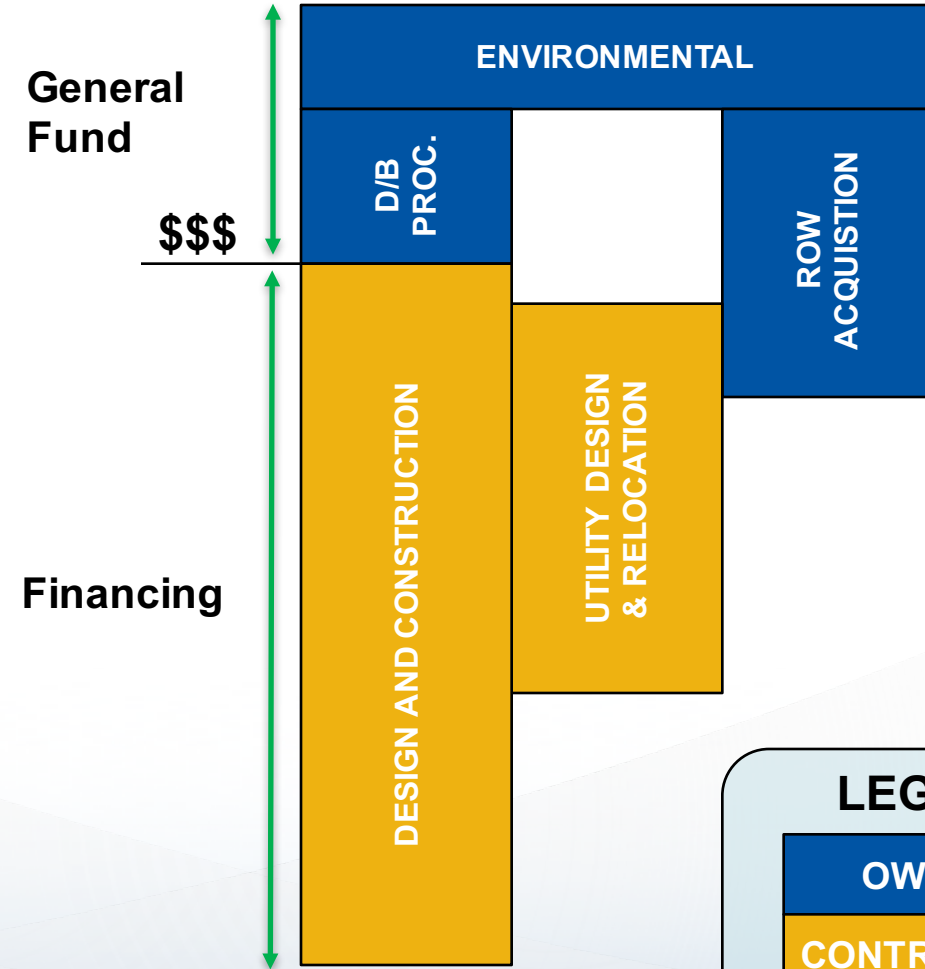



Design-Bid-Build

- Mobility Authority retains full control of designer selection
- Mobility Authority retains full control of design
- Mobility Authority manages pre-construction schedule
- Bidders have clearly defined scope
- Bidders' risk profile is lower and may result in more competitive pricing
- Both design team and contractor are accountable to the Mobility Authority

Design-Build

- Earlier to bond market – can take advantage of favorable interest rates
- Design and Utility Relocation costs are included in financing
- Proposers shortlisted based on qualifications
- Best value selection includes technical proposal and price proposal
- Encourages innovative design
- Single point of liability for design and construction
- Overlap phasing of design and construction can allow construction to begin sooner

Project Funding Sources



Proposed Source	Funding Amount
TxDOT Grant	\$120M
CAMPO STP	\$7M
TIFIA Loan	\$175M
Toll Revenue Bonds	\$228M
Total *	\$530M

* Total project cost with financing

Project Delivery Method Estimated Schedules



183N DESIGN BUILD DELIVERY MODEL

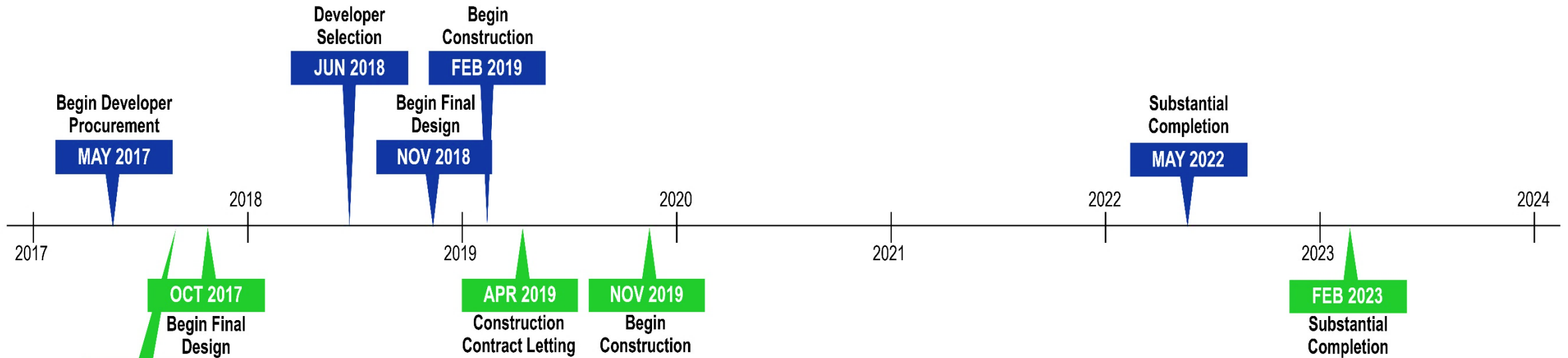

183N DBB DELIVERY MODEL

Recommendation for Design-Build



- **Less financial investment prior to contract execution**
- **Earlier to bond market**
- **Current competitive market conditions favorable for design-build in Texas**
- **Fastest project delivery method to allow for earlier toll collection**
- **Vetting of proposed contractor team**
- **Opportunities for industry feedback during procurement**
- **More ability to align risks to mitigation strategies**
- **Opportunity for increased innovation**

MoPac Improvement Project Monthly Report

Agenda Item #13

Steve Pustelnyk, Director of Community Relations

May 31, 2017



CENTRAL TEXAS
Regional Mobility Authority

Express Lane Performance

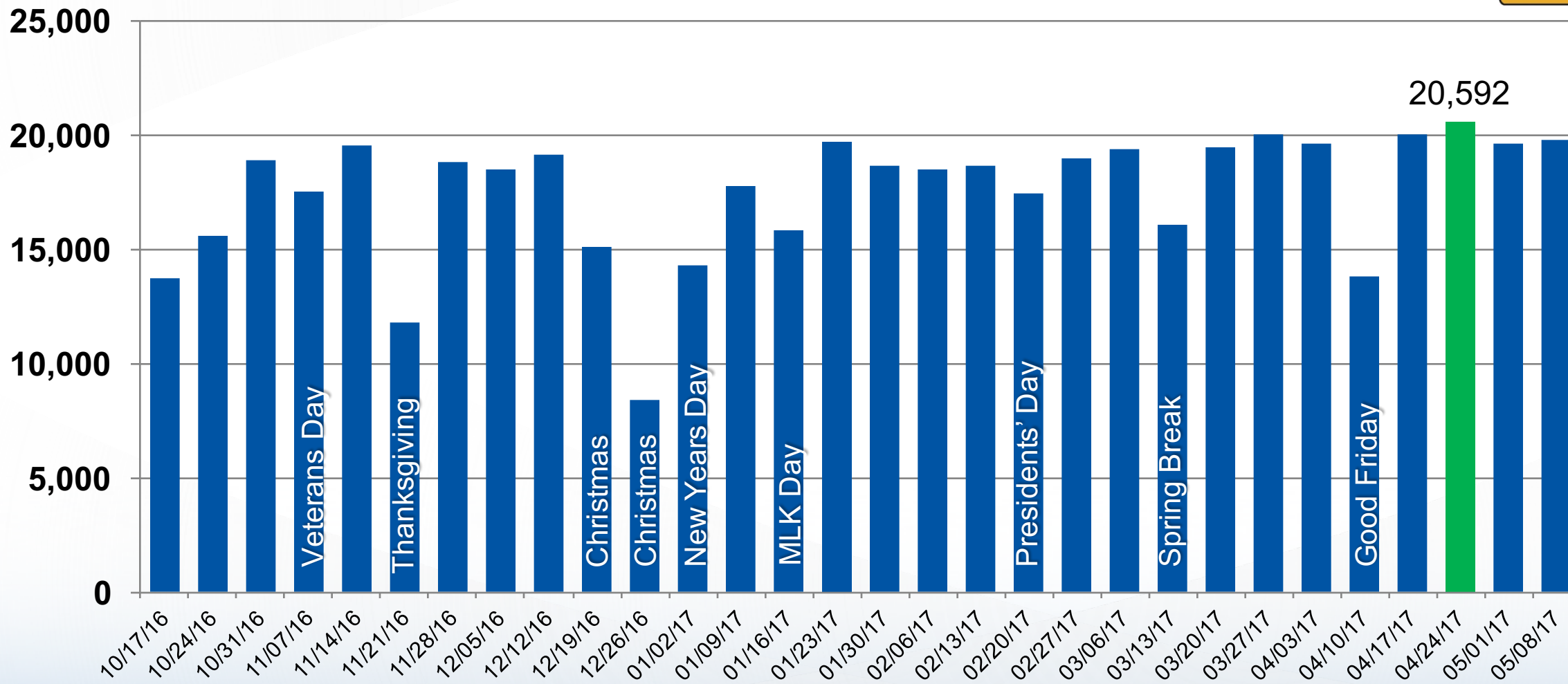
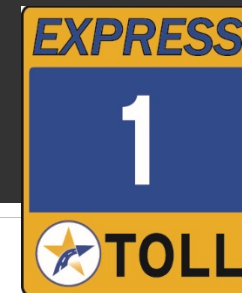

CENTRAL TEXAS
Regional Mobility Authority

Total Transactions by Week

Express Lane Performance

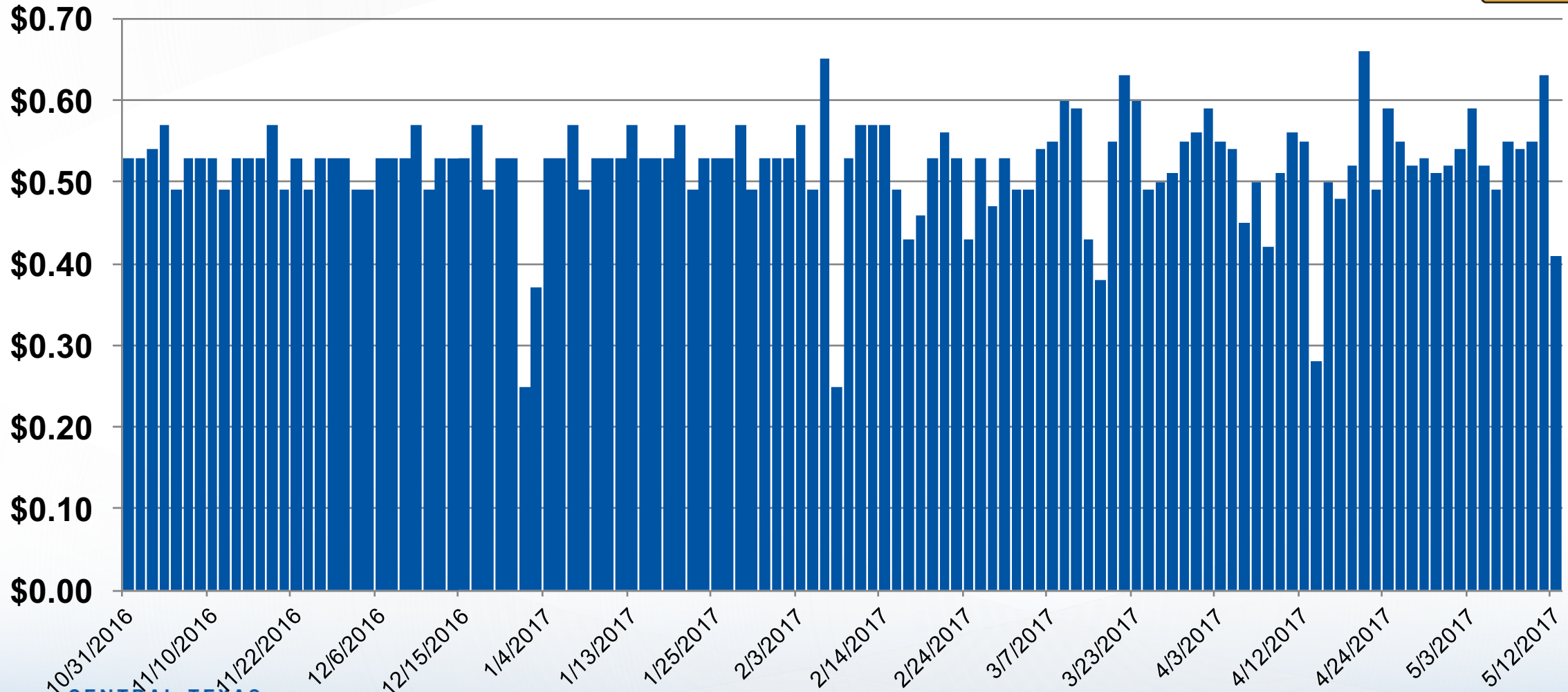

CENTRAL TEXAS
Regional Mobility Authority

Peak Toll Rate by Date



- **Southbound US 183 to RM 2222**
 - begin friction course paving
- **Northbound exit ramp to RM 2222**
 - reopen to traffic
- **Northbound auxiliary lane from 35th Street to 45th Street**
 - reopen to traffic
- **Northbound Cesar Chavez Street to RM 2222**
 - traffic shift and begin paving

Construction Progress



US 183

US 183

RM 2222

RM 2222

Hancock Dr.

Hancock Dr.

45th St.

45th St.

35th St.

35th St.

Westover Rd.

Westover Rd.



Windsor Rd.

Windsor Rd.

Enfield Rd.

Enfield Rd.

Lake Austin Blvd.

5th St.

Cesar Chavez St.

Lady Bird Lake

Friction Course Paving





**Friction
Course
Paving**

Section 3 & 4 – Cesar Chavez to RM 2222

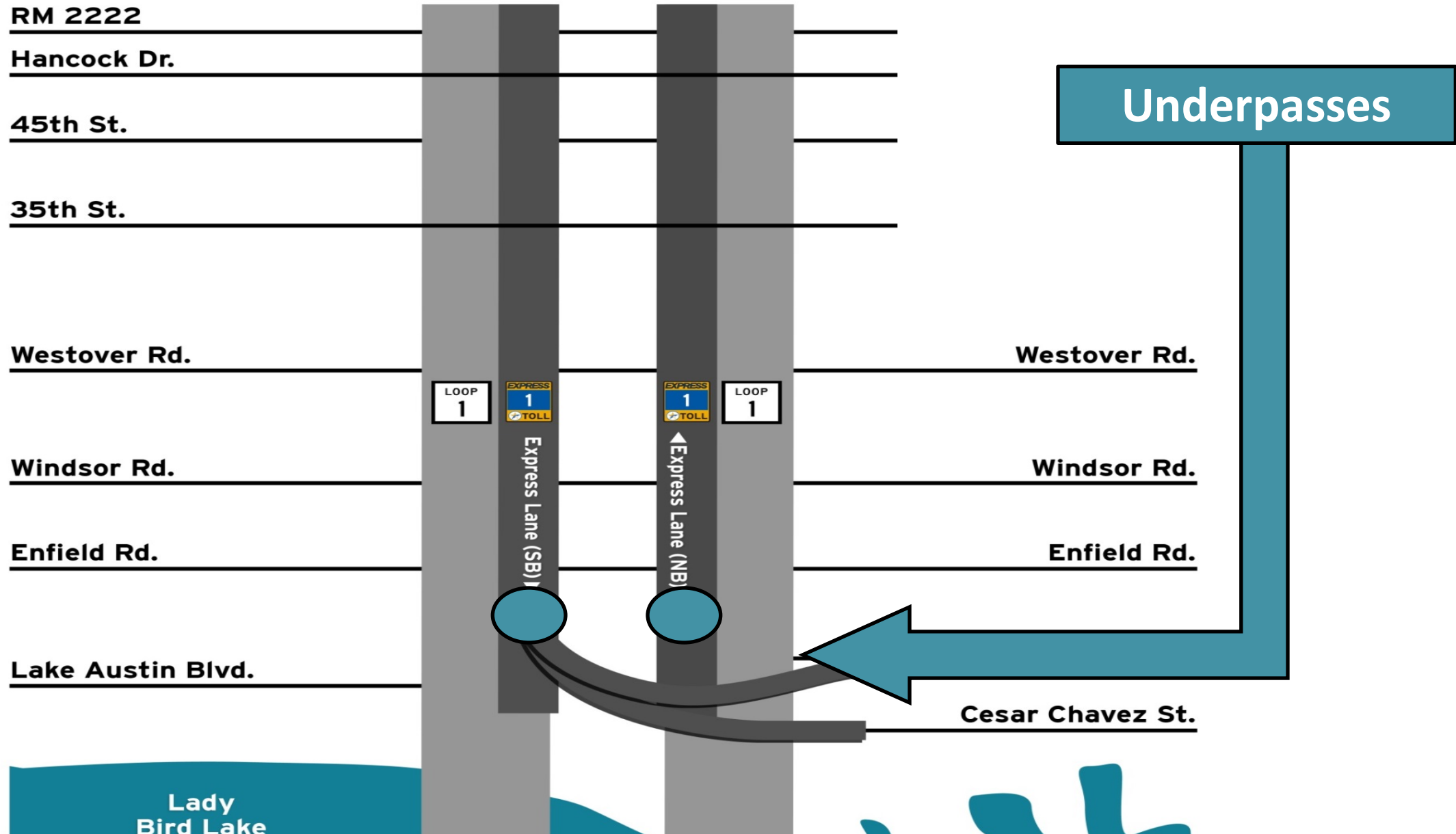

Northbound Underpass

April 2017



Northbound Underpass

May 2017



Southbound Underpass

April 2017



Southbound Underpass

May 2017



Section 3 & 4 – Cesar Chavez to RM 2222

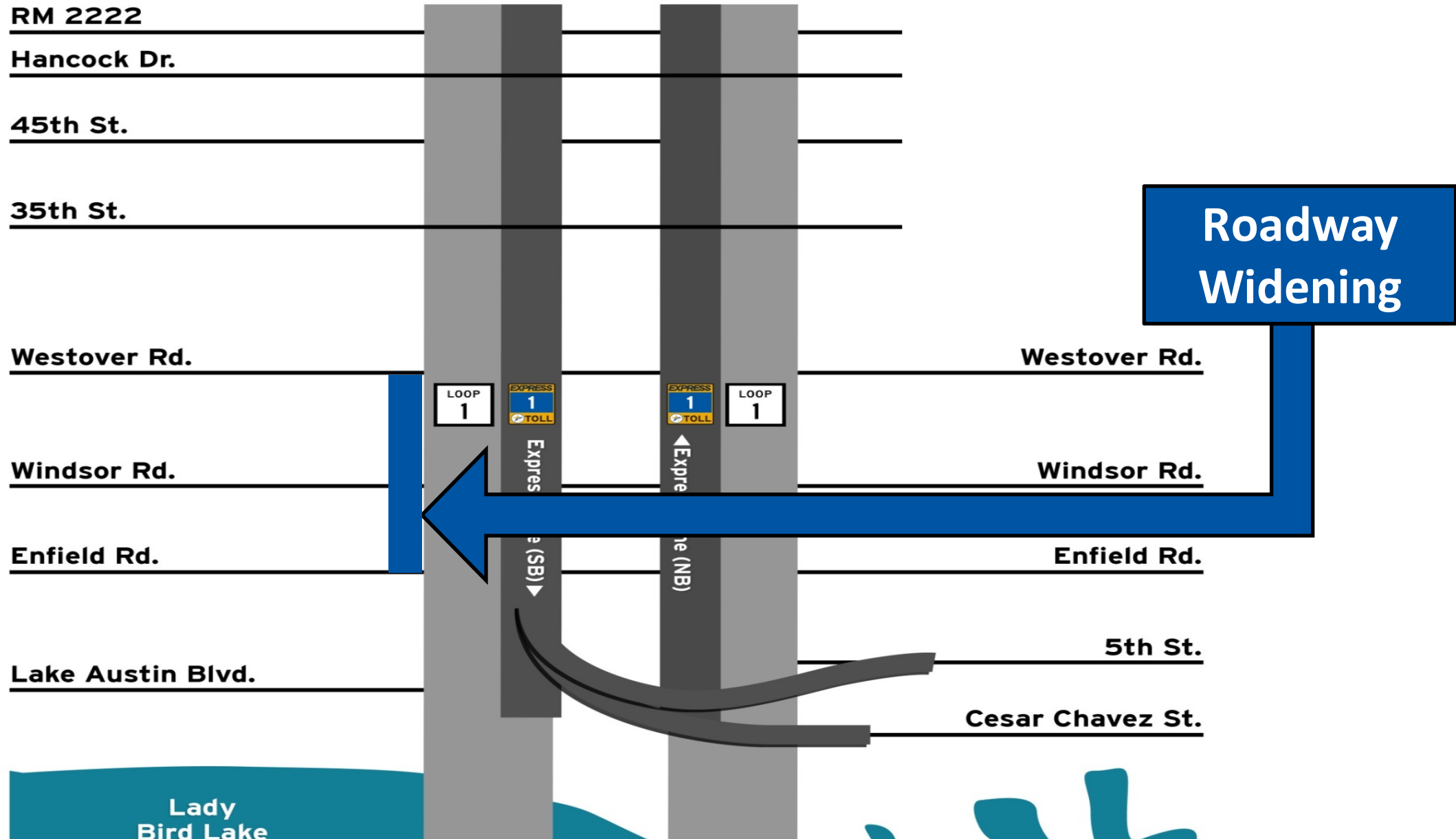

Roadway Widening



Section 3 & 4 – Cesar Chavez to RM 2222

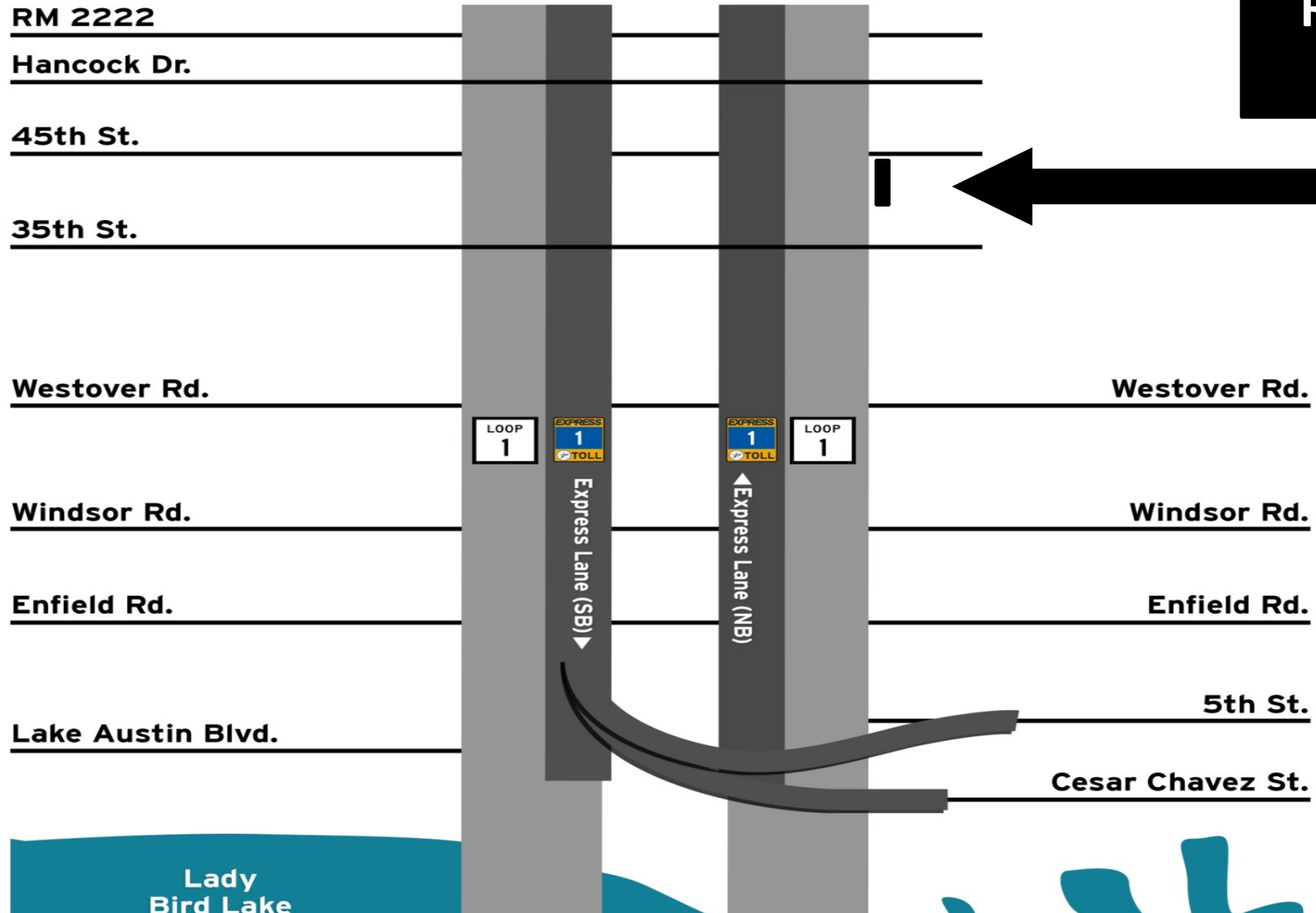

Retaining Wall



Retaining Wall



Section 3 & 4 – Cesar Chavez to RM 2222

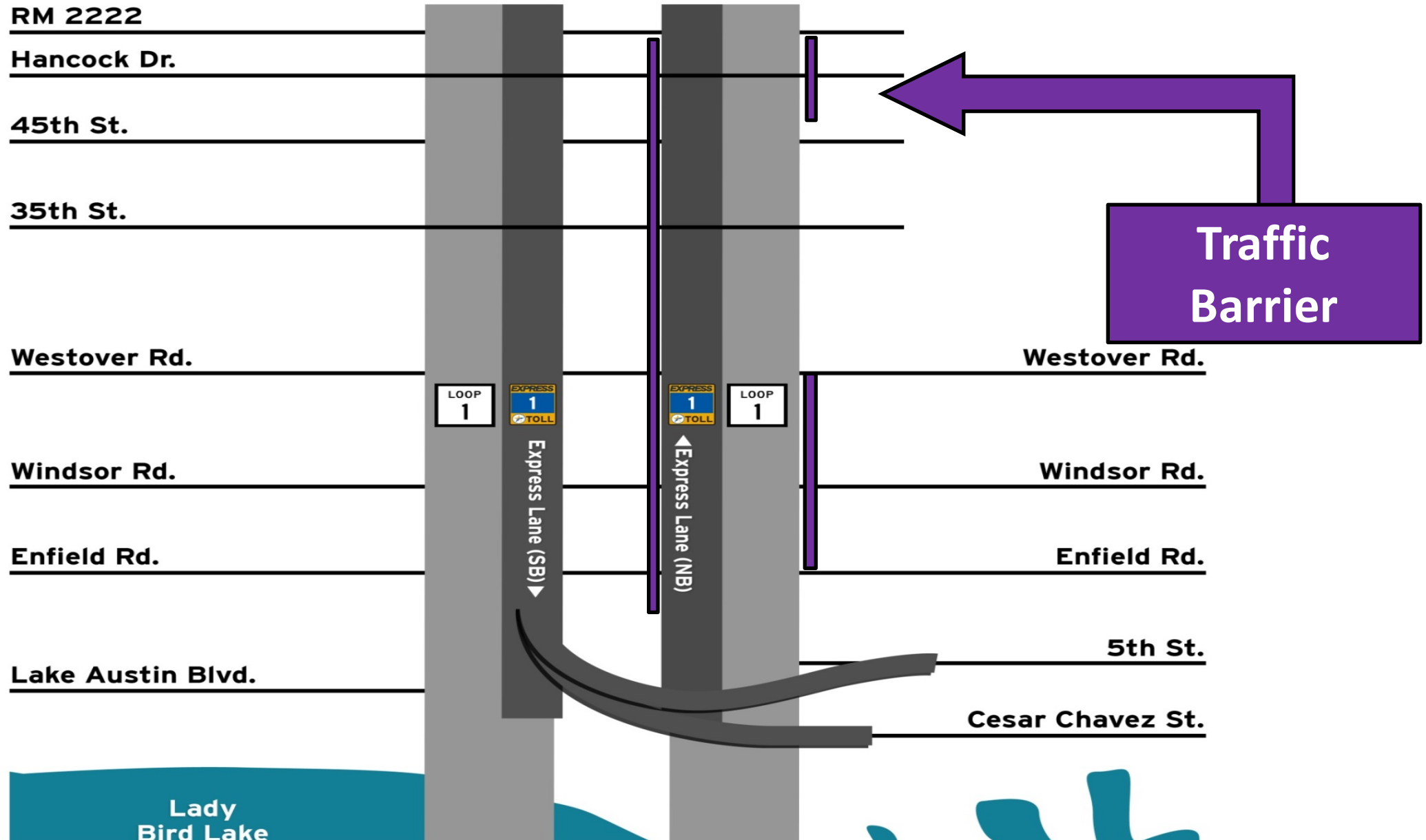



Traffic Barrier

Customer Contact Trends

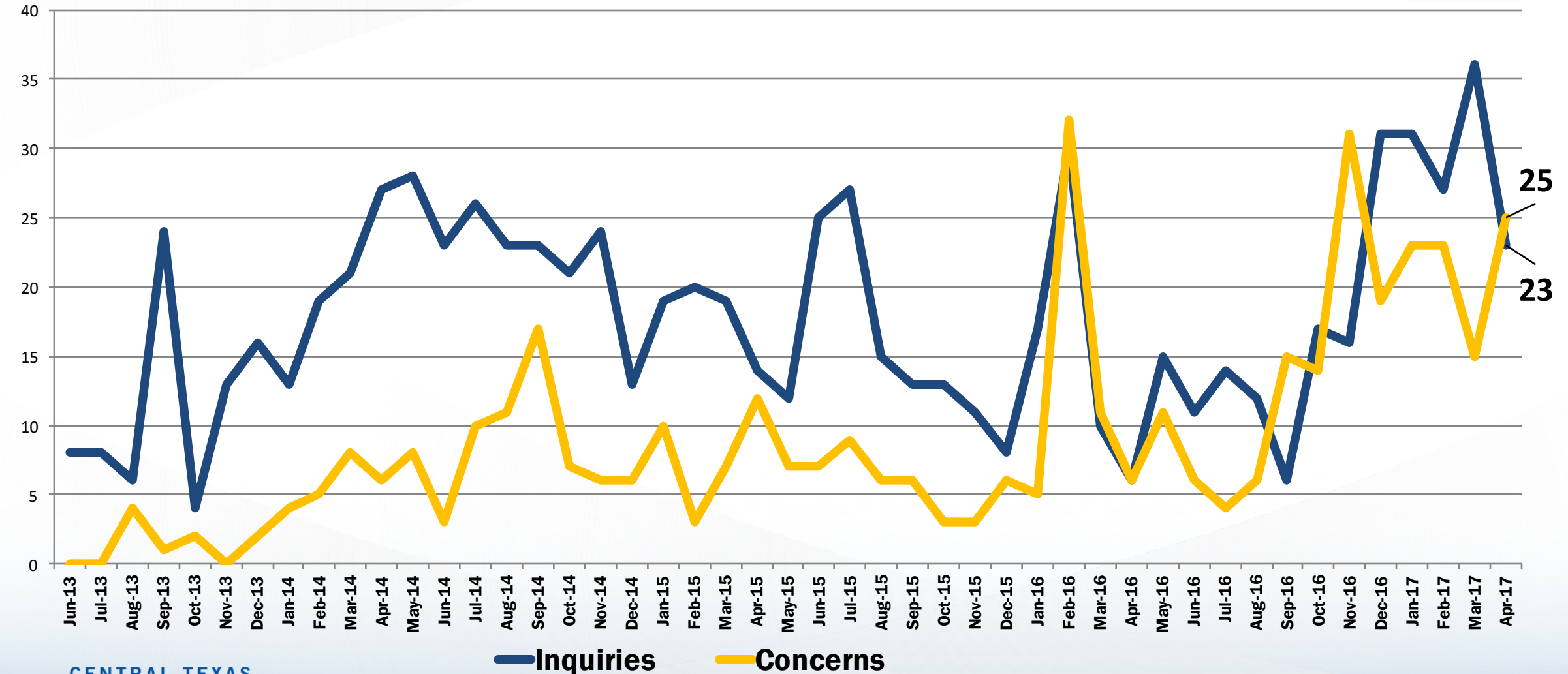

Executive Session

Agenda Items #14-17

May 31, 2017



CENTRAL TEXAS
Regional Mobility Authority

Reconvene in Open Session

April 26, 2017



CENTRAL TEXAS
Regional Mobility Authority

Authorize negotiation and execution of a contract to purchase the following described parcel or property interests for the 183 South (Bergstrom Expressway) Project:

- A. Parcel 157 of the 183 South (Bergstrom Expressway) Project, a fee taking of 0.163 acres, from 0.527 acres of real estate, **owned by Dr. William Selman and Claire Selman**, and located between Vargas Road and Thompson Lane, on Bastrop Highway, Austin TX 78741

Agenda Items #18A

Geoff Petrov, General Counsel

May 31, 2017



CENTRAL TEXAS
Regional Mobility Authority

Authorize negotiation and execution of a contract to purchase the following described parcel or property interests for the 183 South (Bergstrom Expressway) Project:

B. Parcel 158 of the 183 South (Bergstrom Expressway) Project, a fee taking of 0.035 acres, from 4.477 acres of real estate, **owned by Cactus Rose OH Delta, LLC.**, and located at 436 Bastrop Highway, Austin TX 78741

Agenda Items #18B

Geoff Petrov, General Counsel

May 31, 2017



CENTRAL TEXAS
Regional Mobility Authority

Adjourn Meeting

Agenda Item #19

May 31, 2017



CENTRAL TEXAS
Regional Mobility Authority



CENTRAL TEXAS
Regional Mobility Authority