



CENTRAL TEXAS
Regional Mobility Authority

Welcome and opening remarks by the Chairman of the Board of Directors

Agenda Item #1

December 21, 2016



CENTRAL TEXAS
Regional Mobility Authority

Opportunity for public comment

Agenda Item #2

December 21, 2016



CENTRAL TEXAS
Regional Mobility Authority

Regular Items

Agenda Items #3-6

December 21, 2016



CENTRAL TEXAS
Regional Mobility Authority

Approve the minutes for the November 30, 2016 Regular Board Meeting

Agenda Item #3

Geoff Petrov

December 21, 2016



CENTRAL TEXAS
Regional Mobility Authority

Accept the financial statements for November 2016

Agenda Item #4

Mary Temple

December 21, 2016



CENTRAL TEXAS
Regional Mobility Authority

Approve a Request for Proposal for a secured loan for the 290E Phase III Project

Agenda Item #5

Bill Chapman, Chief Financial Officer

December 21, 2016



CENTRAL TEXAS
Regional Mobility Authority

Approve an administrative change order process for use on the SH 45SW Project

Agenda Item #6

Justin Word, P.E., Director of Engineering

December 21, 2016



CENTRAL TEXAS
Regional Mobility Authority

Briefings and Reports

Agenda Items #7-9

December 21, 2016



CENTRAL TEXAS
Regional Mobility Authority

Briefing on the MoPac Improvement Project

Agenda Item #7

Steve Pustelnyk, Director of Community Relations

December 21, 2016



CENTRAL TEXAS
Regional Mobility Authority

Express Lane Performance



Total Weekday Transactions

Week 1	Week 2	Week 3	Week 4	Week 5	Week 6	Week 7	Week 8
13,745 vehicles	15,622 vehicles	18,915 vehicles	17,485 vehicles	19,573 vehicles	11,759 vehicles	18,830 vehicles	18,456 vehicles

Veterans Day

Thanksgiving Holiday

Section 1 & 2 – RM 2222 to Parmer Lane

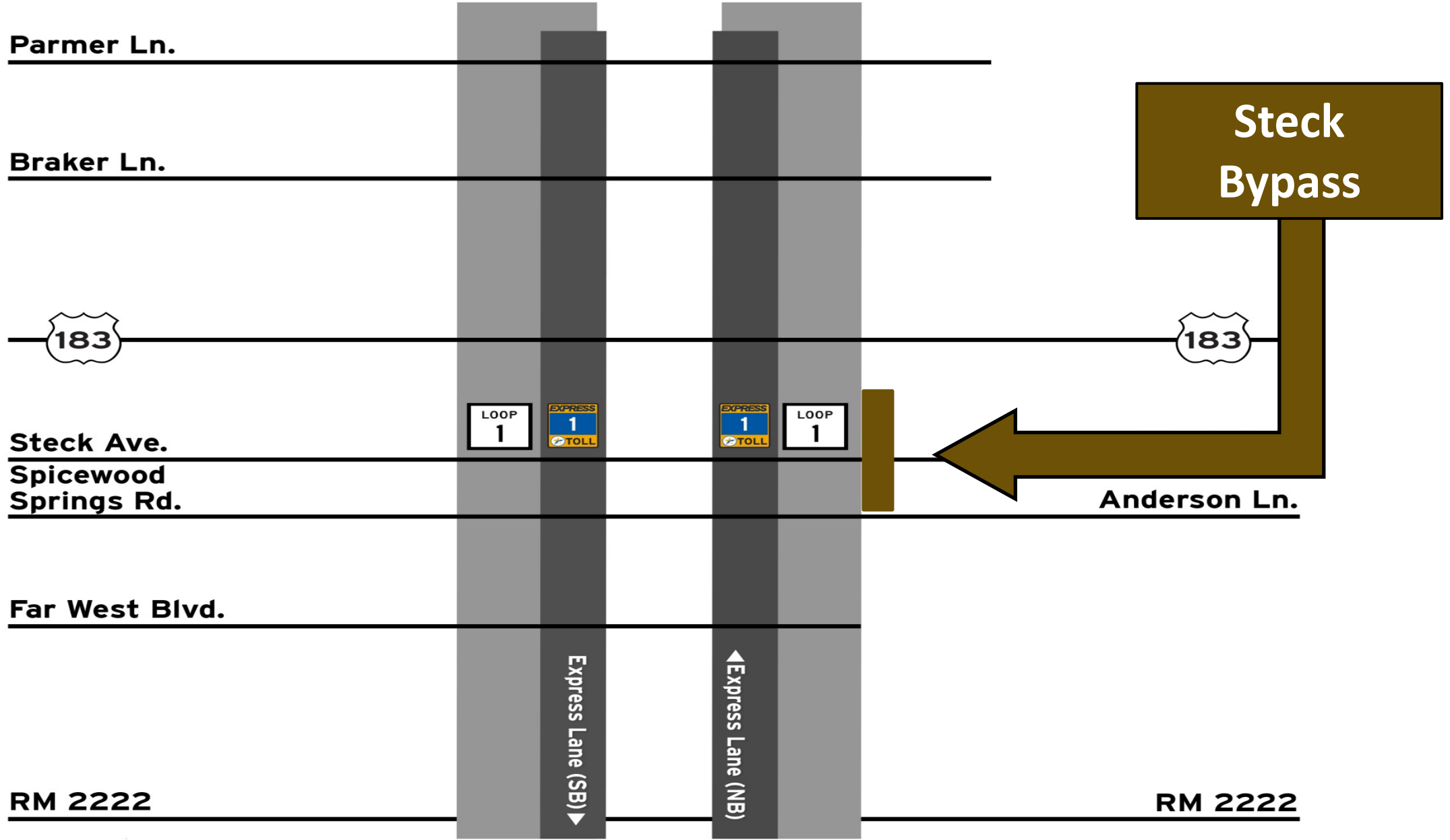

Steck Bypass



Section 1 & 2 – RM 2222 to Parmer Lane

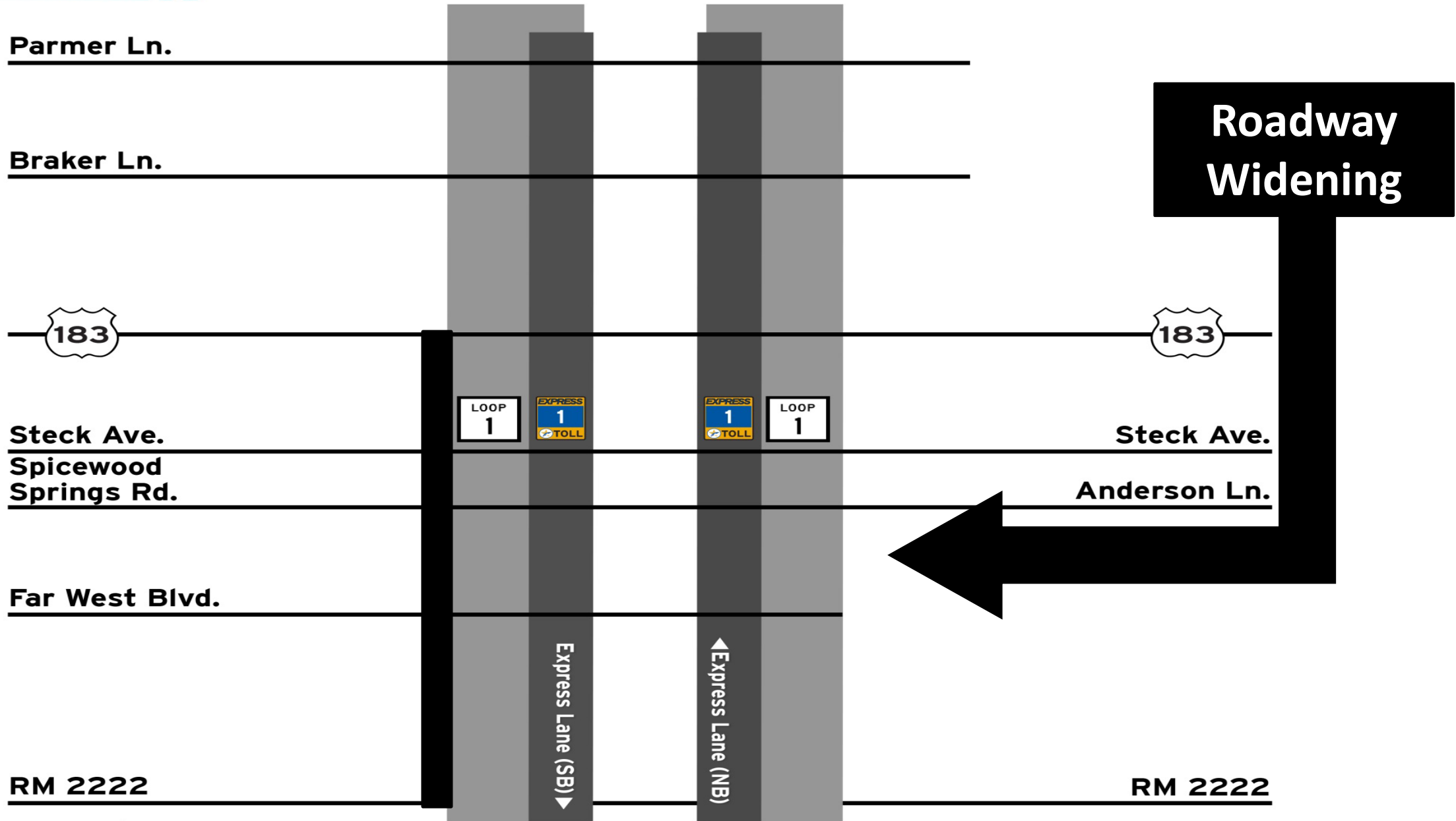



Roadway Widening



Section 1 & 2 – RM 2222 to Parmer Lane

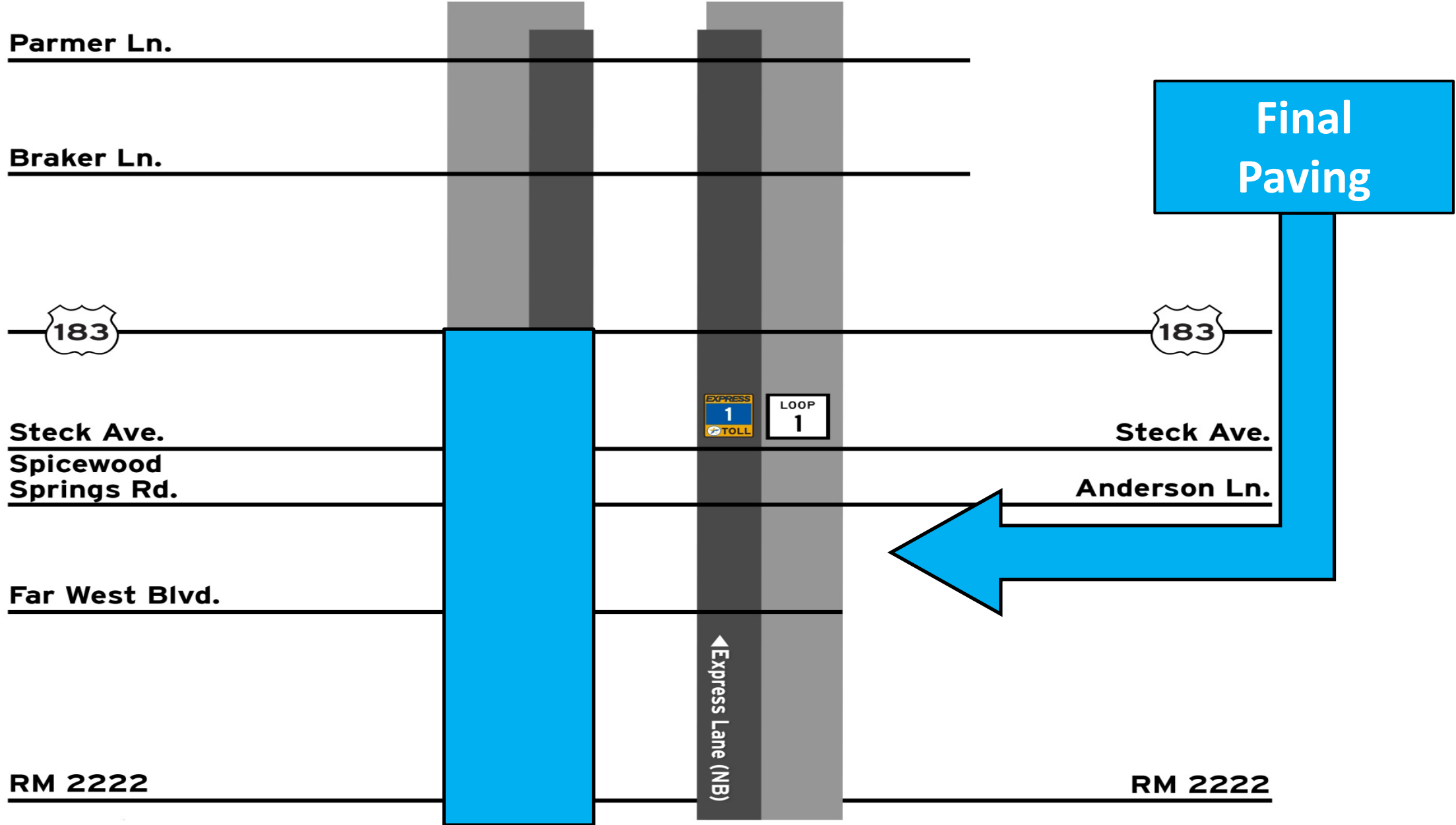

Final Paving



WORK ZONE
SPEED LIMIT 55

EXIT
↑

EXIT TO
Northland Dr
1/2 mi

ENTRANCE
1 mi

LINE
TRAFFIC MAINTENANCE

Section 3 & 4 – Cesar Chavez to RM 2222

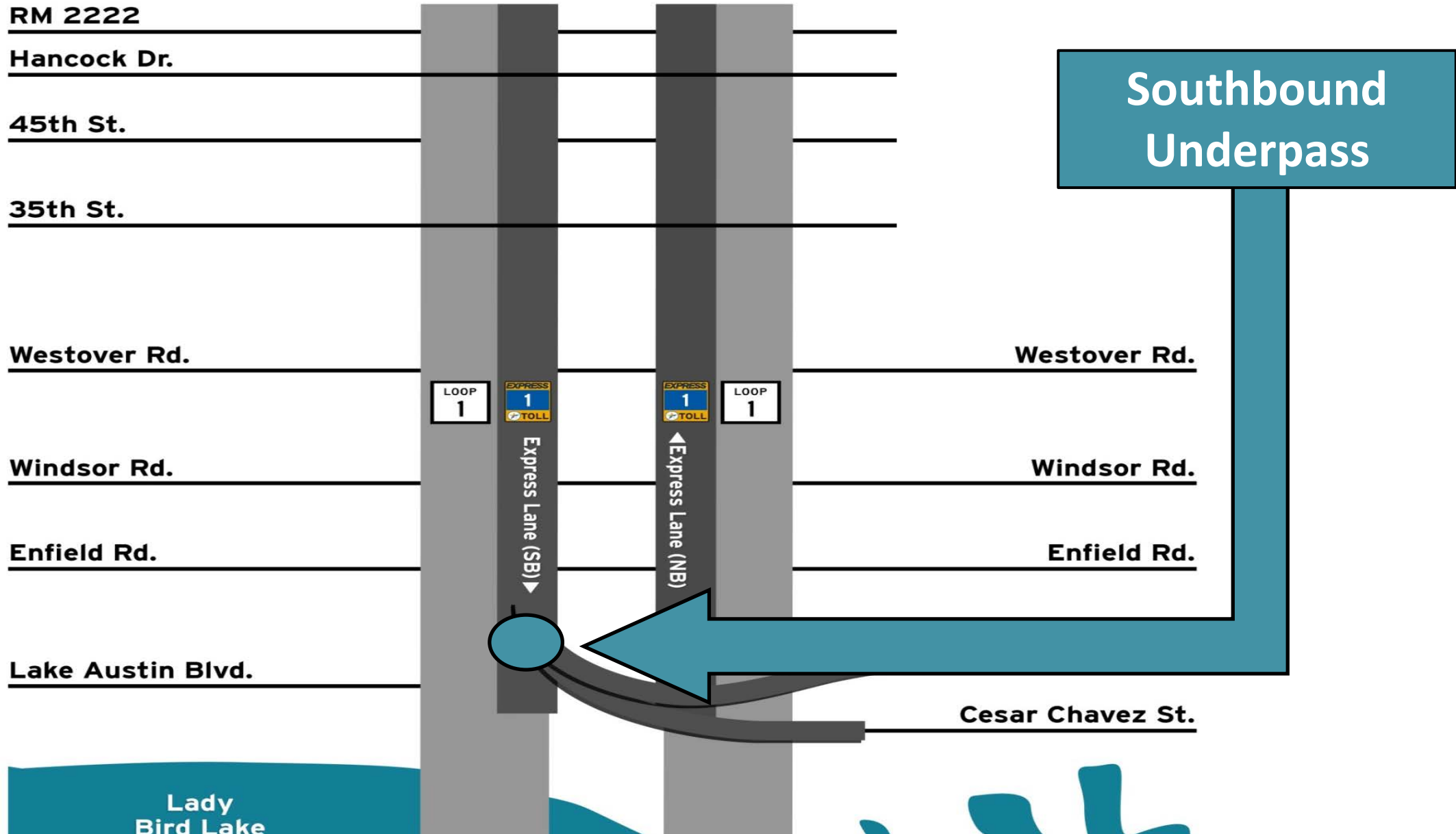



Southbound Underpass



Section 3 & 4 – Cesar Chavez to RM 2222

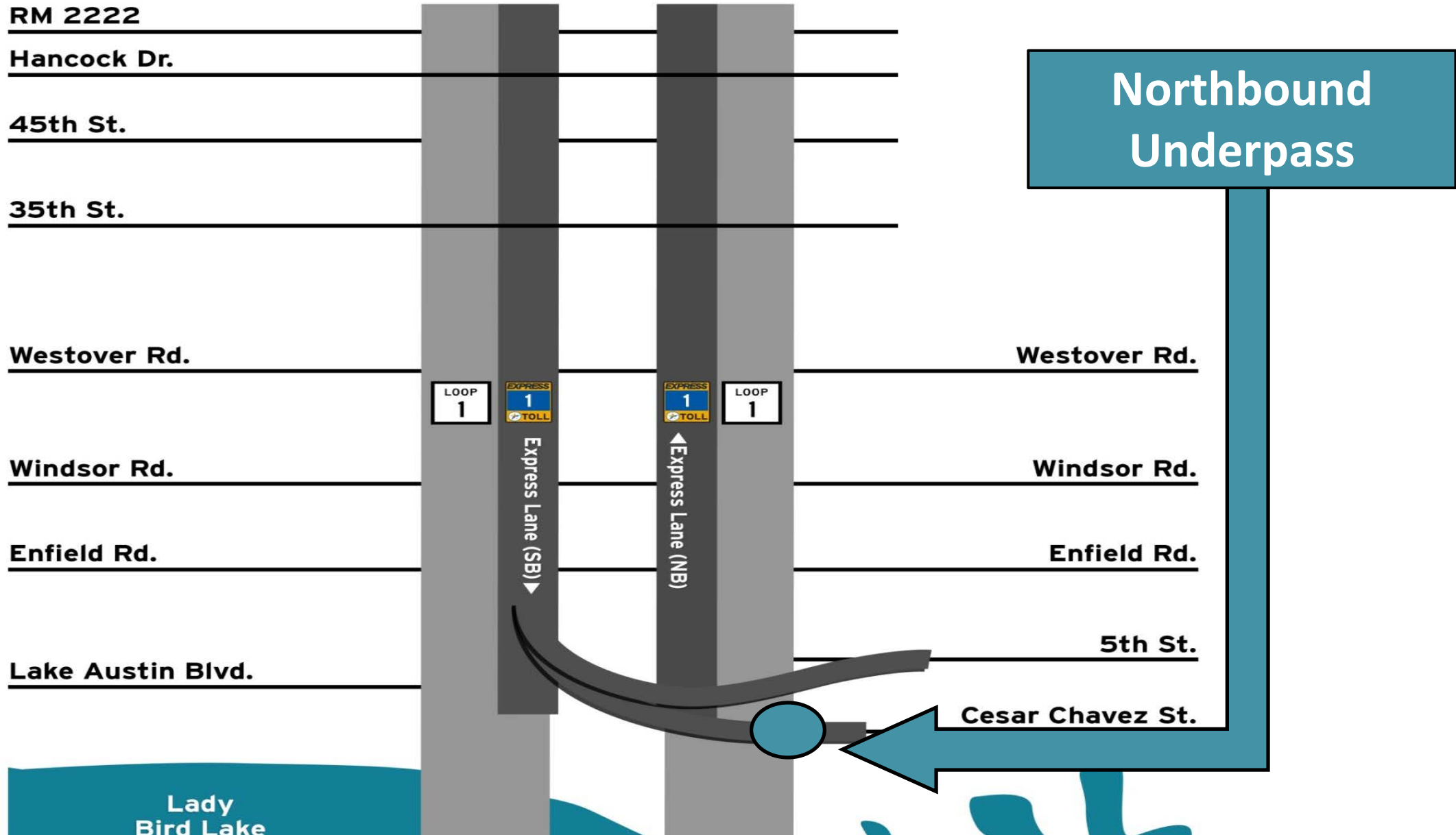



**Northbound
Underpass**



Section 3 & 4 – Cesar Chavez to RM 2222

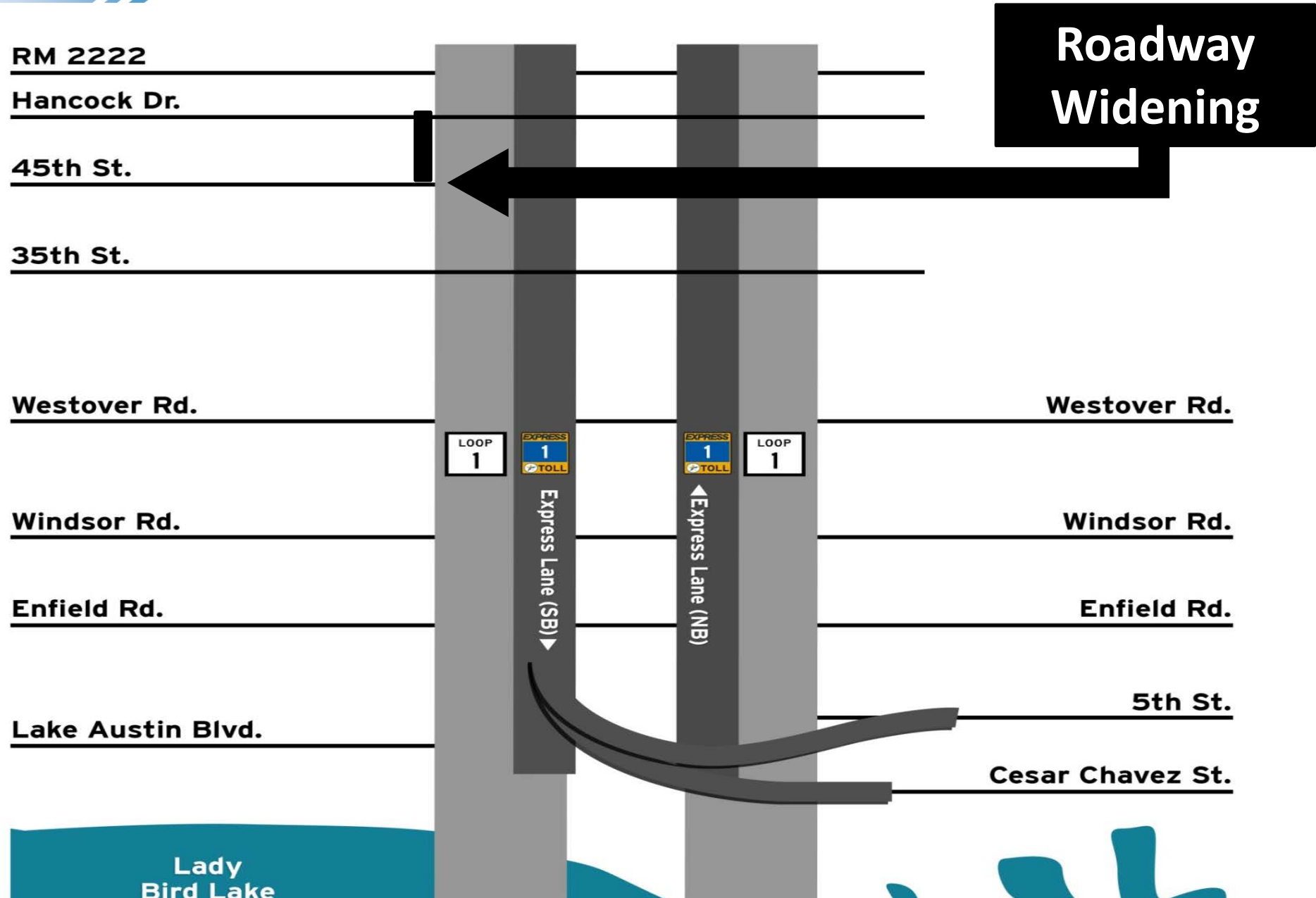

Roadway Widening



Section 3 & 4 – Cesar Chavez to RM 2222

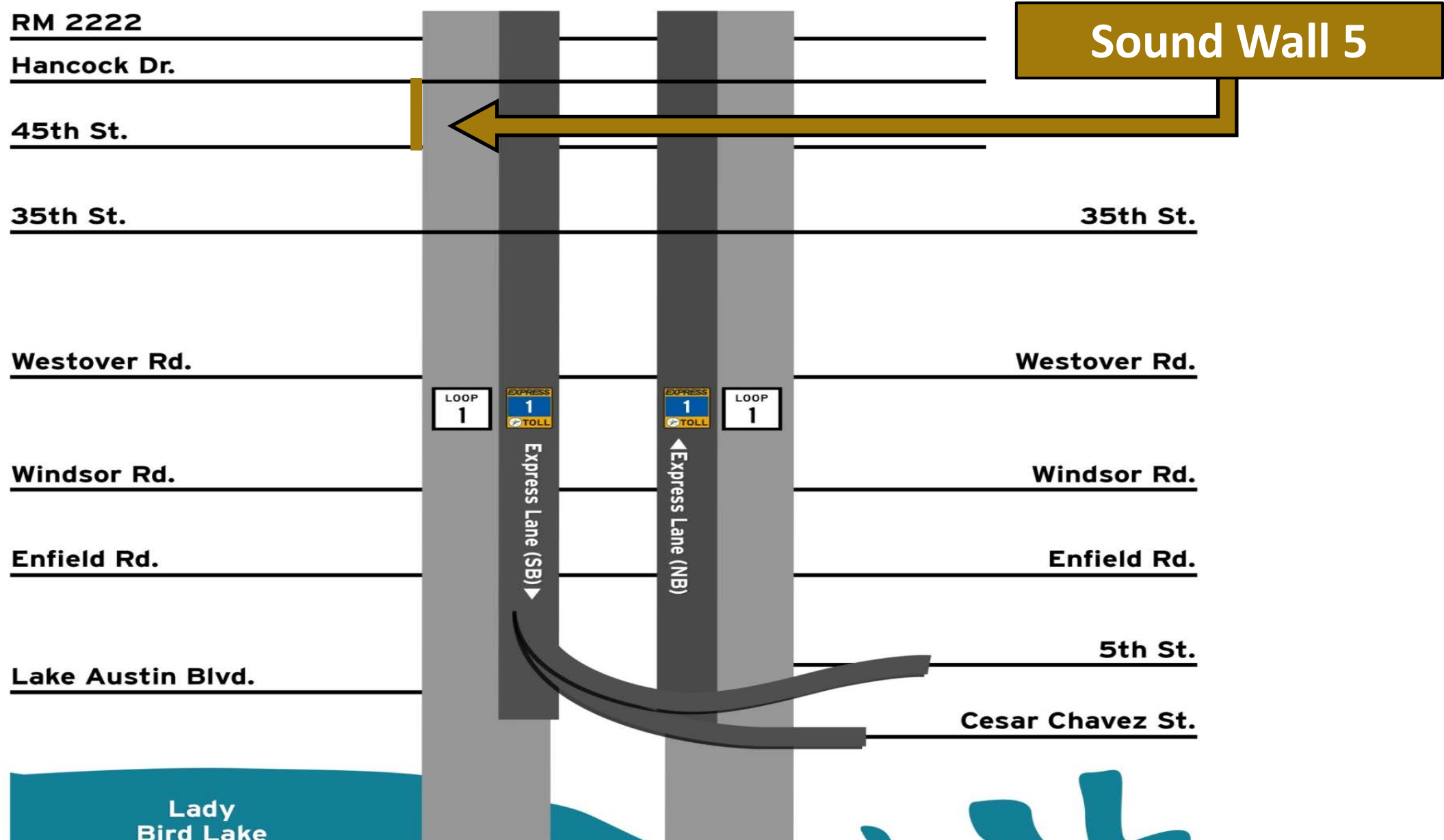



Sound Wall

5

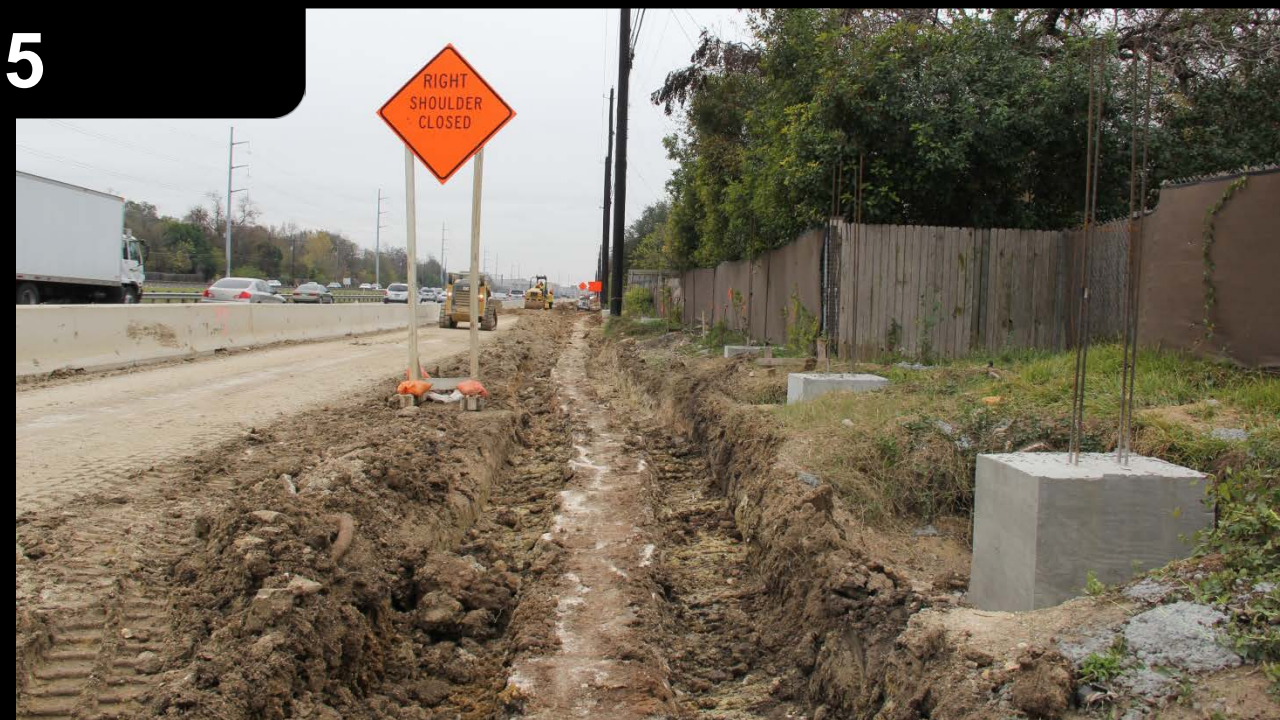

Section 3 & 4 – Cesar Chavez to RM 2222

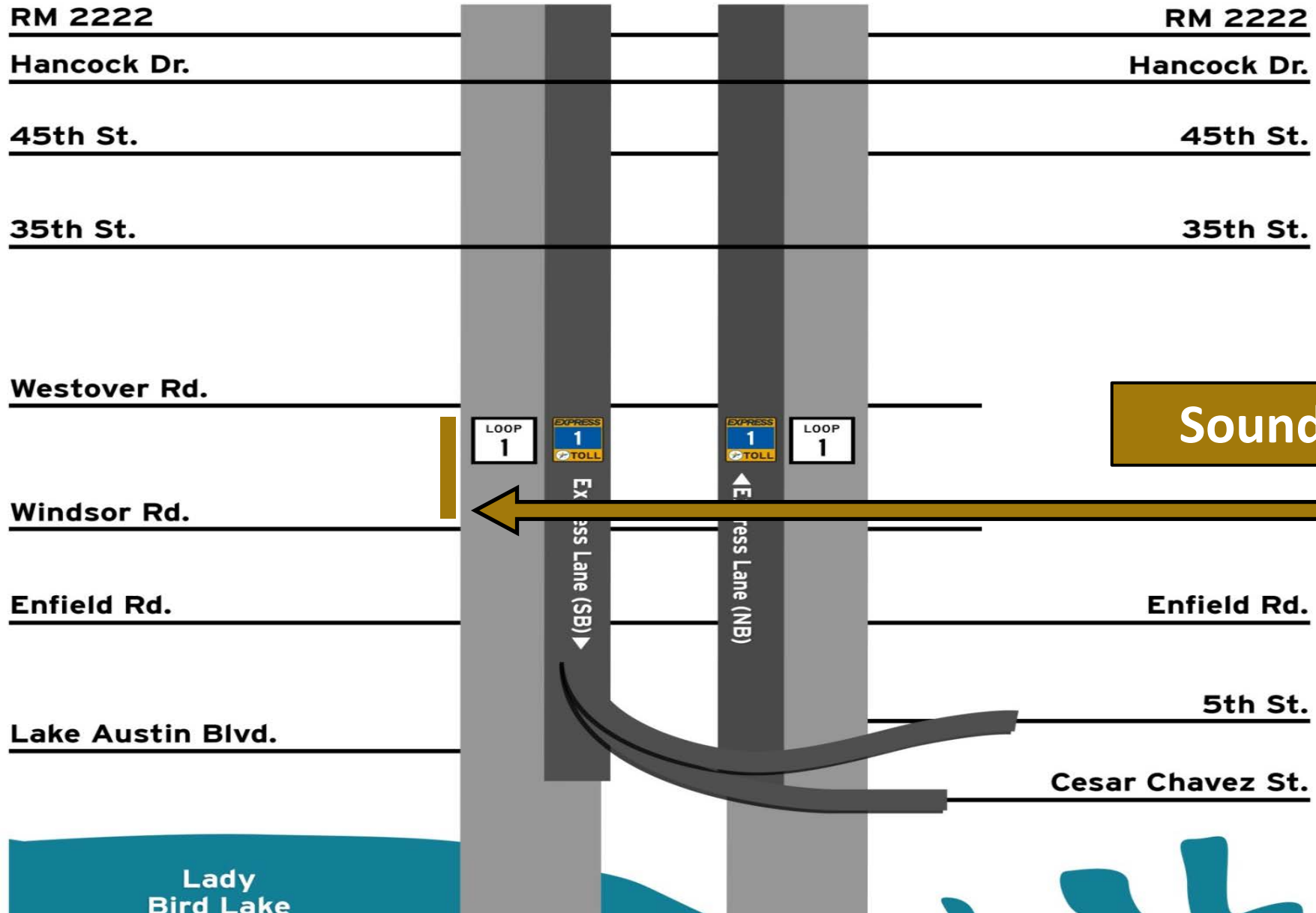



Sound Wall 13



Customer Contact Trends

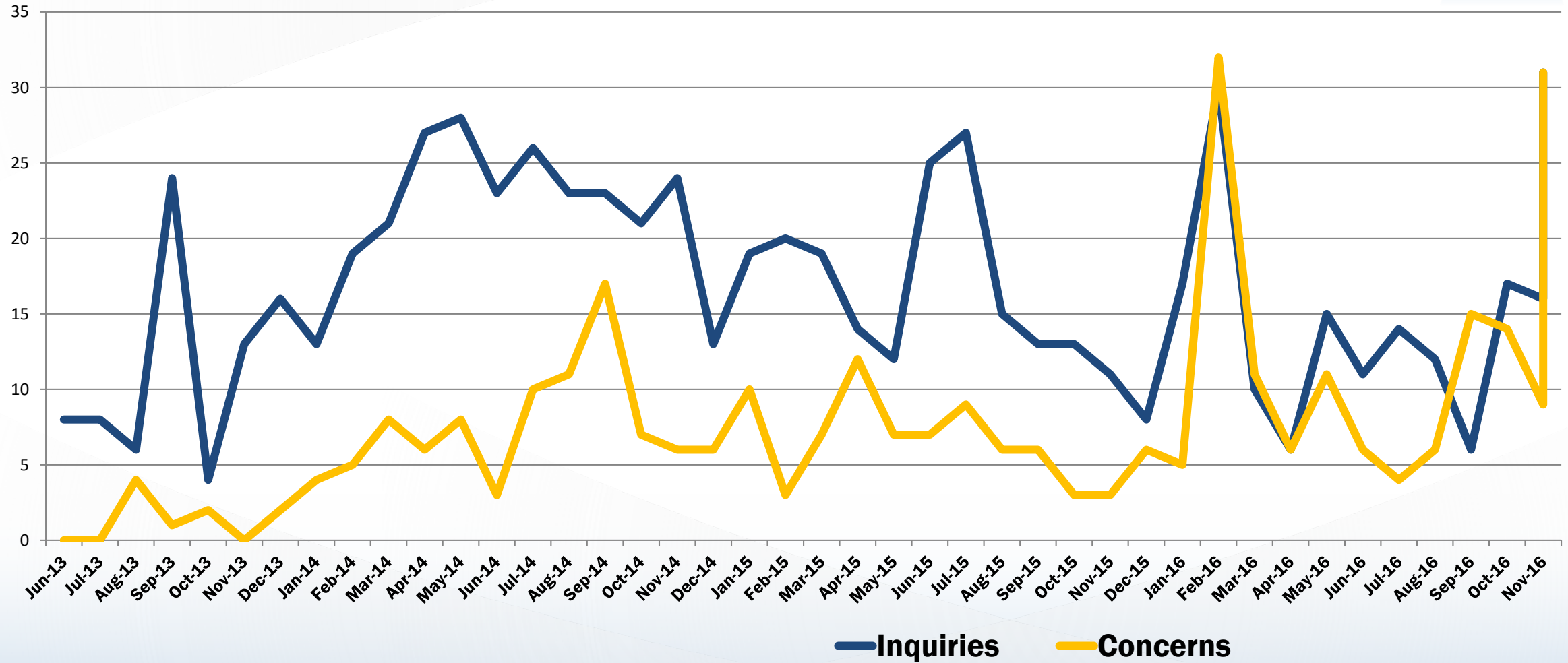

Upcoming Milestones



- **Opening of all Express Lane sections**
 - First half of 2017

Briefing on the SH 45 SW Project

Agenda Item #8

Justin Word, P.E., Director of Engineering

December 21, 2016



CENTRAL TEXAS
Regional Mobility Authority

Current Progress in Construction Work Areas



Green Space 1 (GS1): From 1626 to Bear Creek (Bear Creek Bridge)

↔ Initial Clearing Phase is Complete

↔ Final Clearing Phase Underway

Green Space 2 (GS2): From Bear Creek to the Interchange

↔ Installation of BMPs is Ongoing in Preparation of Initial Clearing

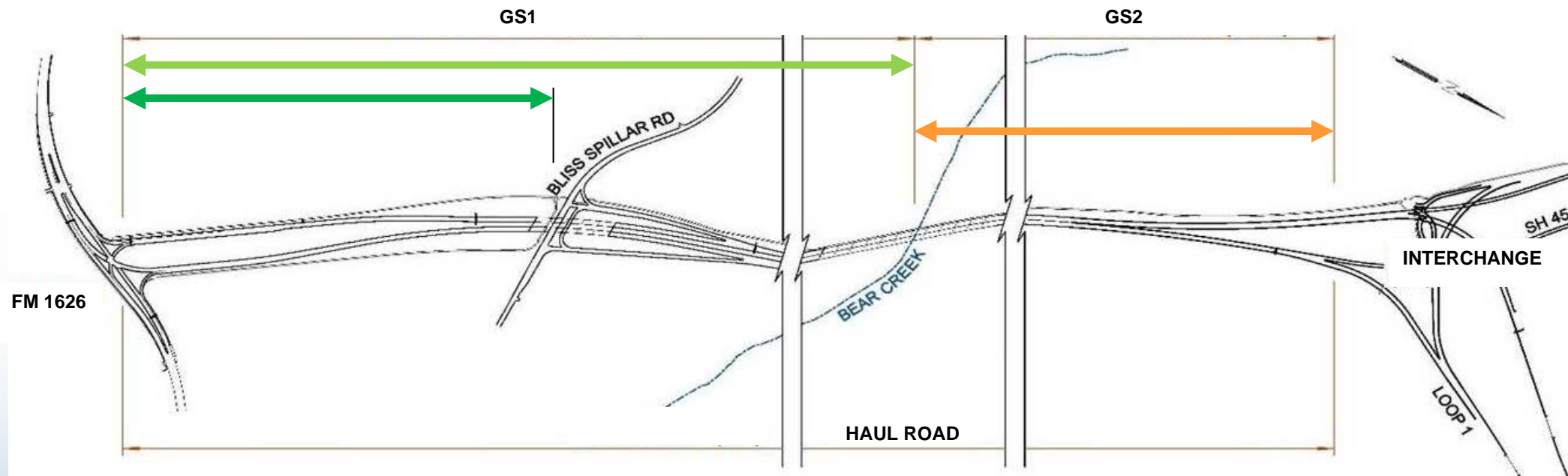

Construction BMPs Placed West of FM1626



Setting Up Construction Exclusion Zones



Rock Filter Dam at Jubilee Cave



Final Clearing Between FM1626 and Old Bliss Spillar Road



Final Clearing and Tree Protection Near Old Spillar Road



Silt Fence with Perimeter Fence Near Bear Creek



Placing Rock Filter Dam at Bear Creek



Mulching Operation



Executive Director's Report

A. MoPac South Project

Agenda Item #9A

Justin Word, P.E., Director of Engineering
Dee Anne Heath, Director of External Affairs

December 21, 2016



CENTRAL TEXAS
Regional Mobility Authority



- 2000 - CAMPO included the MoPac South Project in the 2025 Long Range Transportation Plan (also included in 2005, 2010, 2015 plans)
- 2011 - Rider 42 passed, which focused on the top 50 most congested corridors in Texas – MoPac is listed as 37th
- 2011 - Senator Kirk Watson formed a Mobility Investment Priorities Committee for Central Texas including representatives from CAMPO, Capital Metro, TxDOT, City of Austin, and the Mobility Authority
- 2013 - Committee recommends providing \$16.5 million to study MoPac South from Lady Bird Lake to Slaughter Lane
- 2013 - per the CAMPO plan, the Mobility Authority and TxDOT launch MoPac South Environmental Study



- **Decision Making Agency: TxDOT Environmental Division**
- **Lead Agencies: Central Texas Regional Mobility Authority and TxDOT Austin District**
- **Key Stakeholders: Technical Working Group Invitees**
 - U.S. Army Corps of Engineers
 - Texas Historical Commission
 - Texas Park and Wildlife Department
 - Barton Springs Edwards Aquifer Conservation District
 - Capital Area Metropolitan Planning Organization
 - Capital Metro
 - City of Austin
 - City of Rollingwood
 - City of Westlake Hills
 - U.S. Fish and Wildlife Service
 - U.S. Department of Agriculture
 - *Natural Resources Conservation Service*
 - U.S. Department of Interior
 - *Office of Environmental Policy and Compliance*
 - U.S. Environmental Protection Agency
 - Texas Commission on Environmental Policy and Compliance
 - Lower Colorado River Authority
 - Travis County
 - City of Sunset Valley
 - LBJ Wildflower Center



- CAMPO determines projects to incorporate into Long Range Plan and Board approves commencement of environmental studies
- Approves contracts with firms to provide technical data and to develop Environmental Assessment
- Ensures the NEPA process is followed
- Approves further project development upon completion of environmental review



▪ **TWG Meeting #1 - April 2014**

- Purpose and Need
- Draft evaluation criteria and preliminary alternatives

▪ **TWG Meeting #2 - December 2014**

- Purpose and Need
- Preliminary Alternatives
- Preliminary Schematic

▪ **TWG Meeting #3 - October 2015**

- Six concepts under consideration
- CDM Smith and CTR traffic modeling results
- Environmental Assessment update

▪ **TWG Meeting #4 - February 2016**

- Water quality regulations, existing conditions and potential treatment strategies
- Bicycle and pedestrian facilities
- Possible transit facilitates
- Evaluation criteria



- **Purpose – What are we trying to do?**

- Provide an opportunity for reliable travel times
- Improve operational efficiency
- Create a dependable and consistent route for transit
- Facilitate reliable emergency response

- **Need – What problems are we trying to address?**

- Current and forecasted congestion levels are creating unreliable travel times
- Forecasted population, traffic and employment growth, resulting in increased congestion and delay
- Emergency response times are impacted by traffic congestion



• Evaluation Criteria for Alternatives

- Improvements to operational efficiency
 - Travel times for General Purpose and Express Lane users
 - Consistent with CAMPO Regional Transportation Plan
 - Access and affordability

- Potential impacts to the natural and human environment
 - Visual and noise impacts
 - Park land impact
 - Shared use paths and sidewalks



- Development of Criteria – developed by project team and reviewed by the leading agencies, and TWG under oversight by TxDOT
- Identify and Advance Alternative Concepts - based upon Criteria that evaluate potential environmental impacts, cultural impacts and addresses purpose and need
- Mobility Authority facilitates evaluation and community input – ensures that the NEPA process is followed
- TxDOT Environmental Division with authority from FHWA reviews and approves the Environmental Assessment



Texas Administrative Code Outreach Requirements

- One Official Comment Period
- One 30 day notice and one additional outreach method
- Notification Letter to adjacent property owners

MoPac South Outreach

- 4 Open Houses/Public Meetings
- 4 Virtual Open Houses
- 4 Technical Work Group Meetings
- Four 40 day Official Comment Periods (*150 days more than required*)
- Display advertisements
- Email meeting notification and eNewsletters (900 subscribers)
- Stakeholder Meetings (43 to date)
- Elected official outreach
- Project website (MoPacSouth.com) with continuous online comment capability
- Social media updates and notifications
- 25 Community Calendar postings advertising outreach events
- Media outreach
- Dynamic message boards
- **Solicit, receive and incorporate community input throughout the process**



▪ **November 7, 2013: Open House 1**

- Comment period from October 8 through November 18
- 70 public comments received, both comments and responses are available on the project website, MoPacSouth.com

▪ **April 29, 2014: Open House 2**

- Comment period March 30 through May 9
- 64 public comments received, both comments and responses are available on the project website, MoPacSouth.com

▪ **February 26, 2015: Open House 3**

- Comment period January 29 through March 9
- 253 public comments received, both comments and responses are available on the project website, MoPacSouth.com

▪ **November 10, 2015: Open House 4**

- Comment period October 21 through November 20
- More than 1,500 comments received and were made available online on the project website. Responses will be posted online pending resolution of lawsuit and TxDOT review.



- **Addition of direct connector ramps at US 290** – *City of Austin*
- **Addition of new collector-distributor at Loop 360** – *City of Austin*
- **Direct connector landing shifted farther east on Cesar Chavez Street** – *Austin ISD*
- **Texas Turnarounds at Barton Skyway** – *City of Rollingwood*
- **Reconfiguration of FM 2244 SB exit ramp** – *City of Rollingwood and Stakeholder Comment*
- **Ramp improvements at William Cannon Drive** – *Stakeholder Comment*
- **Additional southbound general purpose lane south of William Cannon Drive** – *Stakeholder Comment*
- **Improvements at Lake Austin Blvd and 5th Street** – *Travis County*
- **Additional Bike/Pedestrian facilities north of FM 2244** – *City of Rollingwood*

Where We Are in the Environmental Study Process



- **Completed**
 - Project Initiation
 - Purpose and Need (defining problem we are trying to solve)
 - Concepts and evaluation (Phase 1 and 2 screening)
- **Next Steps – update for 2040 traffic on-going**
 - Advance Reasonable Alternative for further study
 - Environmental analysis (TxDOT)
 - Preferred Alternative (TxDOT)
 - Open House Meeting (Preferred Alternative presented to the public)
 - Draft Environmental Assessment
 - Conduct Public Hearing
 - Final Environmental Assessment
 - Environmental Finding

Public review and feedback is sought at every stage of study development.



- **Ongoing activities:**

- TxDOT to complete review of technical memorandums and evaluation criteria developed by project team, TWG and public input
- Complete traffic model update and submit to TxDOT TPP

All other activities on hold pending lawsuit.



Jacobs Engineering Invoice History



Executive Session

Agenda Items #10-12

December 21, 2016



CENTRAL TEXAS
Regional Mobility Authority

Reconvene in Open Session

December 21, 2016



CENTRAL TEXAS
Regional Mobility Authority

Adjourn Meeting

Agenda Item #13

December 21, 2016



CENTRAL TEXAS
Regional Mobility Authority



CENTRAL TEXAS
Regional Mobility Authority